

OIL LEVEL & DRAIN PLUG

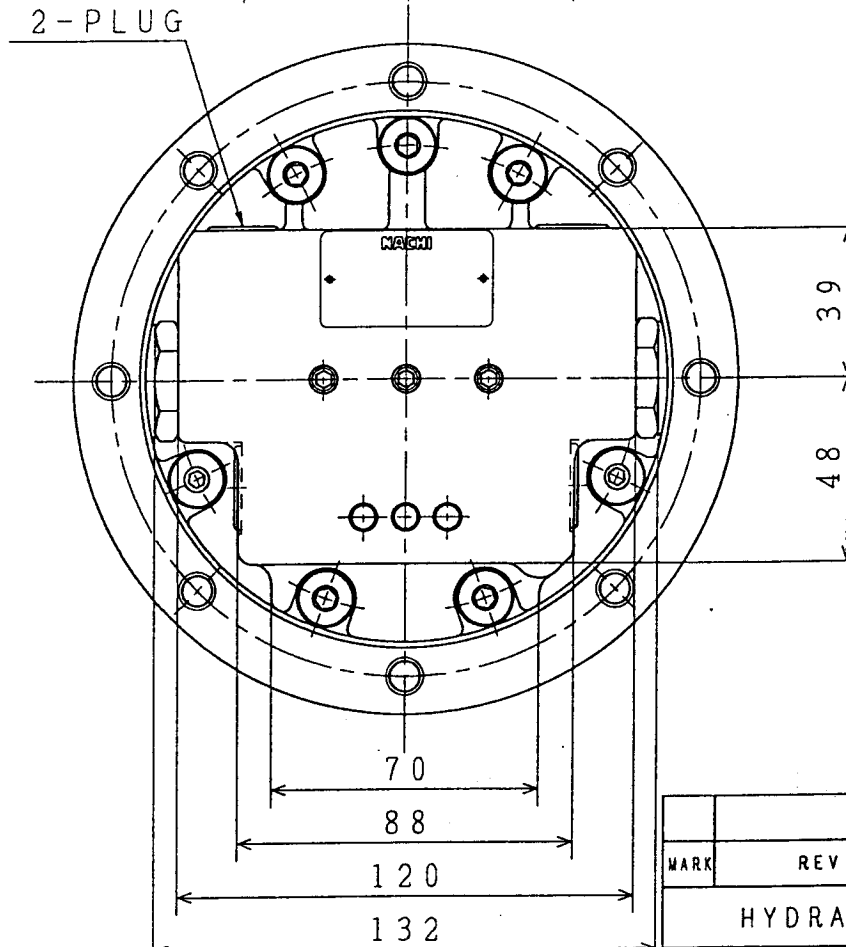
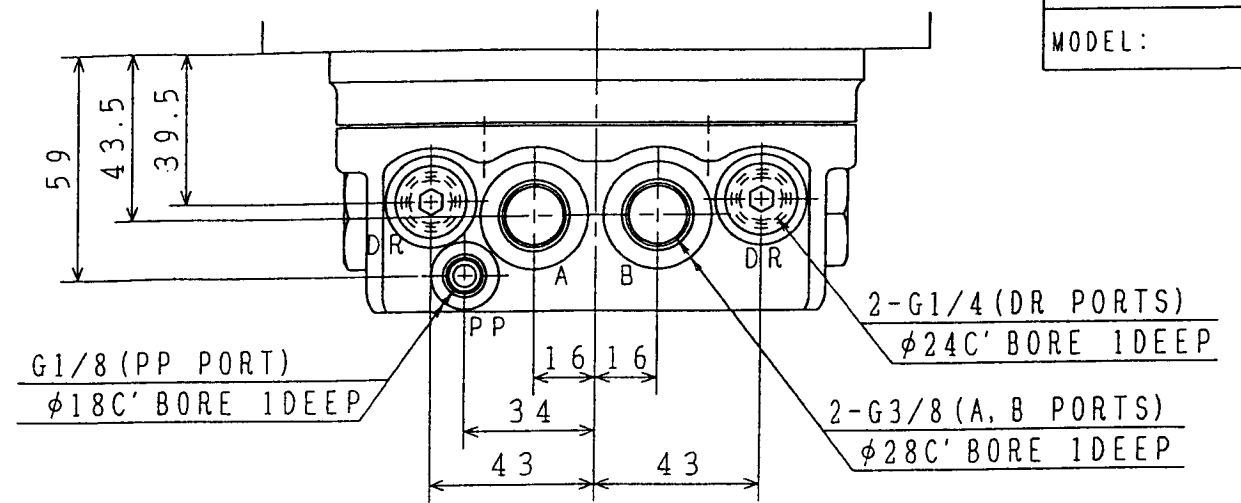
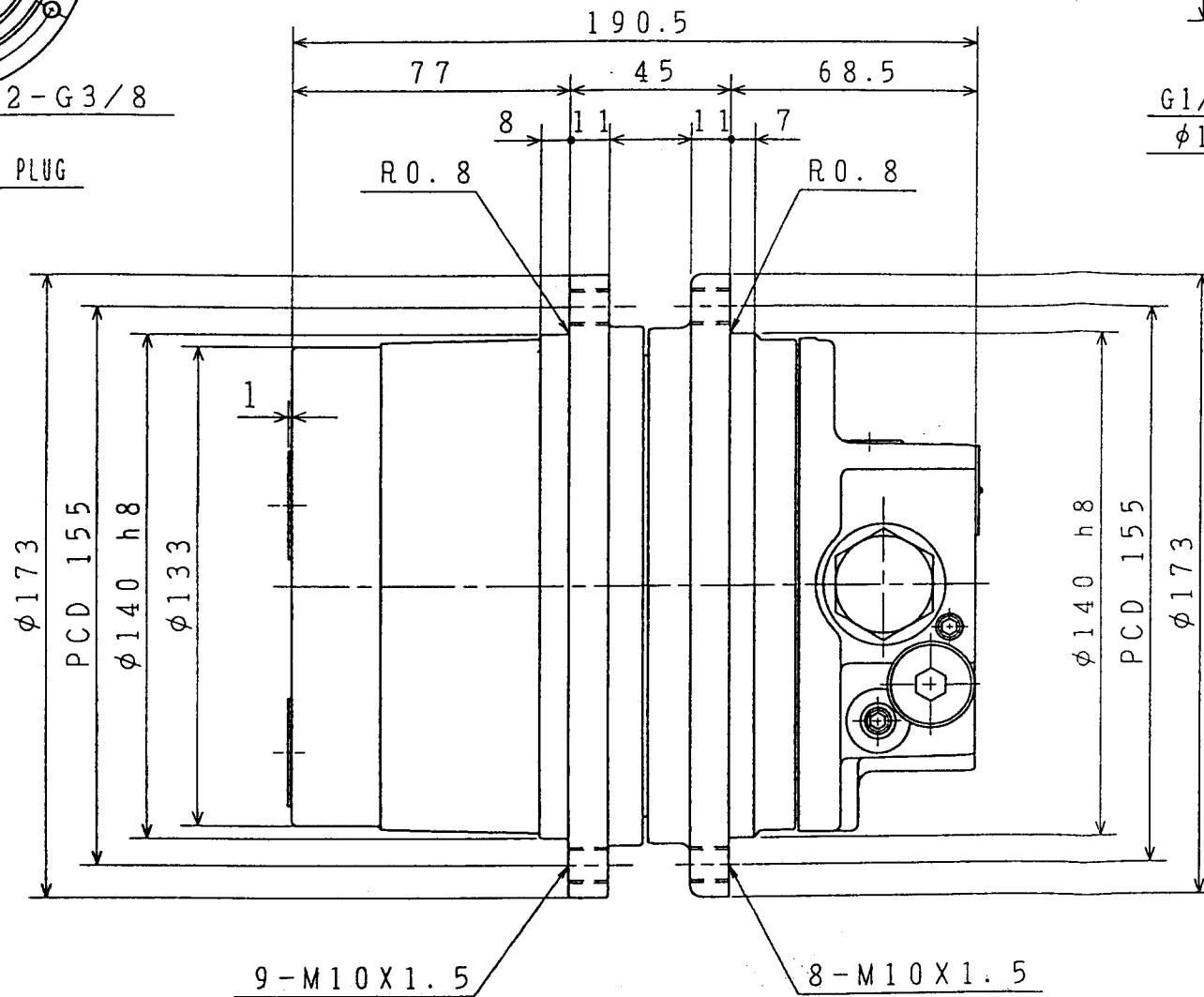

## SPECIFICATION

SPEED REDUCER	MAX. OUTPUT TORQUE	1152 N·m (117 kgf·m)	DISPLACEMENT/FINAL REVOLUTION	458.3/229.2 cm <sup>3</sup> /rev	
	MAX. OUTPUT SPEED	34.2/67.7 min <sup>-1</sup>			
	GEAR RATIO	1/36.96			
HYDRAULIC MOTOR	DISPLACEMENT	12.4/6.2 cm <sup>3</sup> /rev	OTHER	OIL	ISO VG46
	MAX. OPERATING PRESSURE	19.0 MPa (194 kgf/cm <sup>2</sup> )		OIL TEMP.	-20~100 °C
	MAX. OUTPUT SPEED	1264/2503 min <sup>-1</sup>		FILTER	10 μm
	MAX. FLOW	16 l/min		GEAR OIL	SAE-30-CD
	PARKING BRAKE STATIC FRICTION TORQUE	16.7 N·m (1.7 kgf·m)		AMOUNT OF OIL	330 cm <sup>3</sup>
	PARKING BRAKE RELEASING PRESSURE	1.5 MPa (15 kgf/cm <sup>2</sup> )		MASS	17 kg
	SPEED CONTROL PRESSURE	1.5 MPa (15 kgf/cm <sup>2</sup> )		PAINT COLOR	UNDER COAT: RED TOP COAT:
RELIEF VALVE	CRACKING PRESSURE	— MPa at 1/min (— kgf/cm <sup>2</sup> )			
	SETTING PRESSURE	— MPa at 1/min (— kgf/cm <sup>2</sup> )			

### ALLOWED DRAIN PRESSURE

RATED	0.3 MPa   3 kgf/cm <sup>2</sup>
MAX.	1.0 MPa   10 kgf/cm <sup>2</sup>

### ROTATIONAL DIRECTION (VIEWED FROM OUTPUT SIDE)

	INLET	OUTLET
CLOCKWISE	B	A
COUNTER-CLOCKWISE	A	B

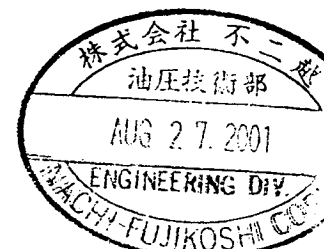

MARK	REVISION	DATE	BY
HYDRAULIC SYMBOL			
MODEL NO.	PHV-120-37B-1-8091Z		
NAME	WHEEL MOTOR		

